

Honeypot Lane, Stanmore, HA7

£280,000

🛏️ 2 🚿 1 🚗 1



- First floor maisonette
- Good size kitchen
- Own rear garden
- 37 years remaining on lease
- Close to Queensbury Circle Parade
- Two bedrooms
- Family bathroom / wc
- Cash buyers only
- Communal front garden
- Close to Queensbury and Canons park stations

GROUND FLOOR
29 sq.ft. (2.6 sq.m.) approx.

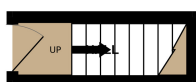

1ST FLOOR
622 sq.ft. (57.8 sq.m.) approx.

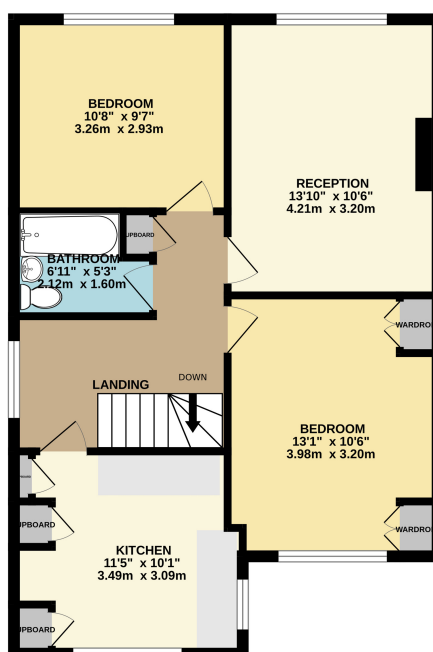

TOTAL FLOOR AREA: 651 sq.ft. (60.5 sq.m.) approx.

Whilst every attempt has been made to ensure the accuracy of the floorplan contained here, measurements of doors, windows, rooms and any other items are approximate and no responsibility is taken for any error, omission or mis-statement. This plan is for illustrative purposes only and should be used as such by any prospective purchaser. The services, systems and appliances shown have not been tested and no guarantee as to their operability or efficiency can be given.
Made with Metropix ©2022.

CASH buyers only for this two bedroom first floor maisonette as the lease has only 37 years remaining so will not be suitable for a mortgage. This well presented property has two double bedrooms, good size kitchen, bathroom / wc, large landing, approx 35' x 28' own rear garden (which is currently overgrown) and a communal front garden. Ground rent is £15.75 pa, building insurance is £647 pa and there is no service charge. EPC Rating: E. Located close to local shops at Queensbury Circle Parade and Queensbury and Canons Park stations.